

MESUCO 132X rapid

Con INDAmatic integrado

- > INDAmatic en el brazo de la bisagra para un cierre suave y silencioso
- > El sistema de amortiguación es completamente invisible.
- > Programa: bisagra estándar a 110° recta, acodada y superacodada.
- > La MESUCO 132X montaje clip está concebida para puertas de 14 a 26 mm de espesor.
- > Cierre uniforme y amortiguado garantizado, sin necesidad de montaje extra.



INDAmatic

1 FAMILIA DE BISAGRAS

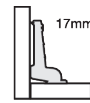
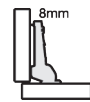
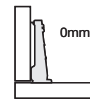

988.715.066*

* Se suministra bajo pedido.

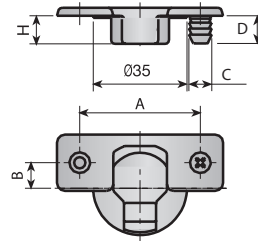

NIQUEL

A:48, B:6

A:45, B:9.5

Montaje
tirafondos

Montaje Directo
D:10

Montaje Expand
D:10

Montaje
tirafondos

Montaje Expand
D:10

<p>110° $\alpha = 0^\circ \div 110^\circ$ H = 11.3</p>	normal	0mm.	320.010.062	320.020.061	320.030.060	320.110.066	320.130.064
		8mm.	320.011.064	320.021.063	320.031.062	320.111.061	
		17mm.	320.012.066	320.022.065	320.032.064	320.112.063	
<p>165° $\alpha = 0^\circ \div 165^\circ$ H = 11.3</p>		0mm.	320.040.066			320.140.063	
<p>90° $\alpha = 90^\circ \div 200^\circ$ H = 11.3</p>		0mm.	320.090.061				
<p>$\alpha = 45^\circ \div 155^\circ$ H = 11.3</p>		0mm.				320.180.066	







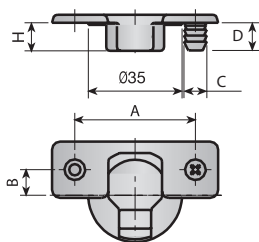





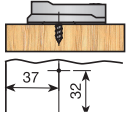

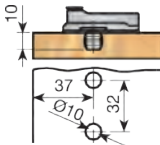

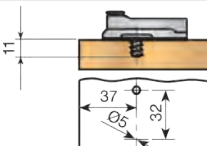
988.715.066*

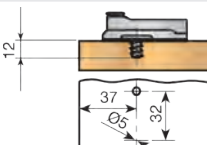
* Se suministra bajo pedido.

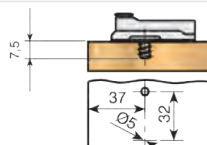

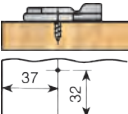
NIQUEL			
A:52, B:5.5			
Montaje Tirafondos	Montaje Directo D:10	Montaje Expand D:10	Eurocrew premontado
320.210.063	320.220.062	320.230.061	320.330.065
320.211.065	320.221.064	320.231.063	320.331.060
320.212.060	320.222.066	320.232.065	320.332.062

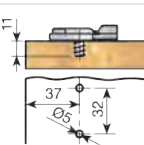
2 PLACAS BASE

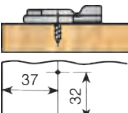
CALCES en mm.			0	2	4	
		Base montaje tirafondos Regulación vertical ± 2 mm	Acero Niquel	350.210.066	350.212.063	350.214.060
		Base montaje directo Regulación vertical ± 2 mm	Acero Niquel	350.220.065	350.222.062	350.224.066
		Base euro-screw premontado Regulación vertical ± 2 mm	Acero Niquel	350.230.061	350.232.061	350.234.065
		Base con centrador Regulación vertical ± 2 mm	Acero Niquel	348.500.062	348.502.066	348.504.063
		Base con centrador corto Regulación vertical ± 2 mm	Acero Niquel	390.010.062	390.012.066	
		Base montaje tirafondos Regulación vertical $\pm 1,6$ mm excéntrica	Acero Niquel	348.600.066	348.602.063	
		Base euro-screw premontado Regulación vertical $\pm 1,6$ mm excéntrica	Acero Niquel	348.400.065		
		Base montaje tirafondos Regulación vertical ± 2 mm	Acero Niquel	350.215.063		

3 DATOS TÉCNICOS

MESUCO 132X RAPID Apertura 110°

Recta



Cálculo de Calce
 $C = B + K - D$
 $K = \text{Constante} = 10,5\text{mm}$

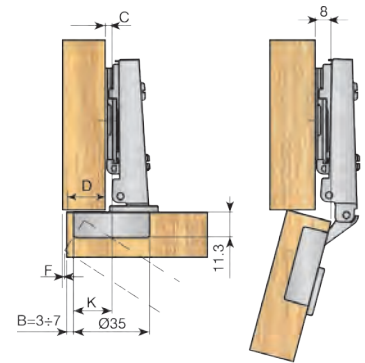

Acodada



Cálculo de Calce
 $C = B + K - D$
 $K = \text{Constante} = 2,5\text{mm}$

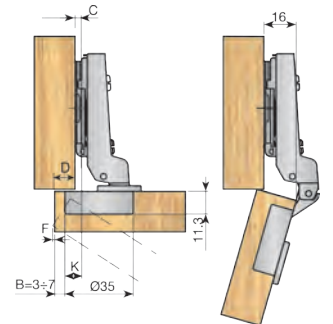

Supercodada*



Cálculo de Calce
 $C = B + K + D$
 $K = \text{Constante} = -6,5\text{mm}$

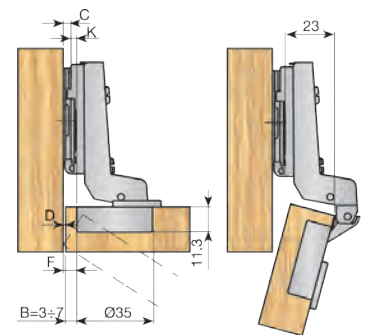

* Se debe retroceder la posición de fijación de la placa una distancia igual al espesor de la puerta más 1mm

Desplazamiento lateral de la puerta (F).

mm	Espesor de la puerta								
B	16	17	18	19	20	21	22	23	24
3	0,8	1	1,4	1,8	2,2	2,8	3,5	4,3	5,0
4	0,8	1	1,4	1,7	2,1	2,7	3,3	4,3	4,7
5	0,8	1	1,4	1,6	2,0	2,5	3,1	3,7	4,4
6	0,8	1	1,4	1,6	2,0	2,4	2,9	3,5	4,1
7	0,7	0,9	1,2	1,5	1,9	2,3	2,8	3,3	3,8

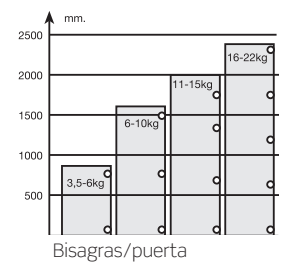
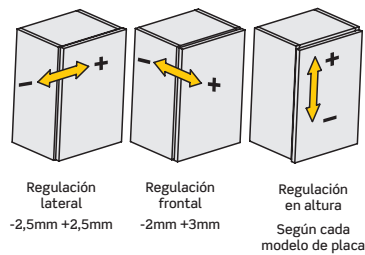

4 EMBELLECEDORES

Embellecedor de bisagra.

Recta	Niquelado	302.431.065
Acodada / Superacodada	Niquelado	302.531.062

El embellecedor puede ser personalizado mediante estampación o serigrafía.

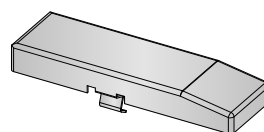

Recta

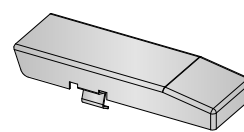

Acodada / Superacodada

Reductor de ángulo de apertura para bisagra 110°

Blanco	352.600.006
--------	-------------

